

TRAFFIC CONTROL SYMBOL LEGEND

- DELINEATOR 
- WORK AREA 
- TCP 
- BUS STOP 

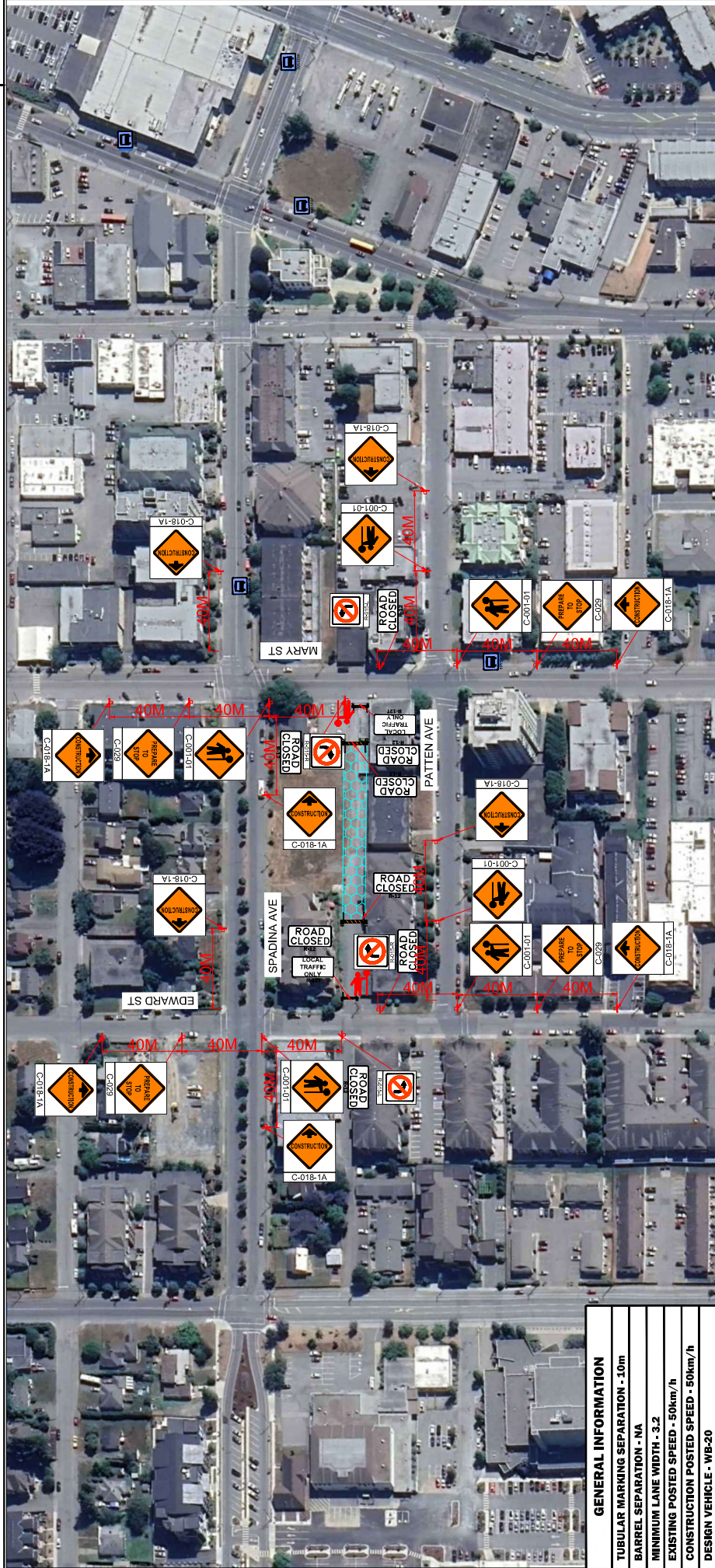

GENERAL INFORMATION

- TUBULAR MARKING SEPARATION - 1.0m
- BARREL SEPARATION - NA
- MINIMUM LANE WIDTH - 3.2
- EXISTING POSTED SPEED - 50km/h
- CONSTRUCTION POSTED SPEED - 50km/h
- DESIGN VEHICLE - WB-20

GENERAL NOTES

1. Traffic Specifications based on MOTM TMM For Work on Roadways 2020
2. Hours of work: 7AM-7PM
3. Site Contact: John Vander Hoek 604-615-2477
4. All work to be completed by 7:00 AM on Monday, August 1, 2022
5. TCP's to assist with pedestrians when necessary. Pedestrian access to be maintained at all times
6. Existing lane alignment to be reinstated at the end of each shift
7. CMBC to be contacted prior to work commencing

REV	DESCRIPTION	DATE	INITIAL	WAY TO GO TRAFFIC SOLUTIONS	DWG No. 01	Road Closure on Laneway South of Spadina Avenue
0	ISSUED FOR INFORMATION	03.25.24	AME	PROJECT: 48700 Spadina Avenue, Chilliwack B.C.	SCALE:	
				CLIENT:		



KOPER & COMPANY
 TRAFFIC SERVICES
 2191 GREVLYNN CRES.
 NORTH VANCOUVER, BC